

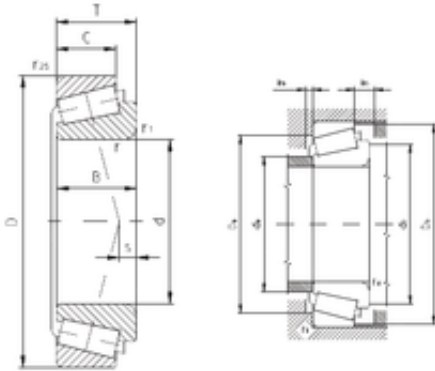

## New energy Bearing Manufacturing Co.,...

50 mm x 82 mm x 21,5 mm ZVL K-  
JLM104948/K-JLM104910 tapered roller bearings



Bearing No. K-JLM104948/K-JLM104910

K-JLM104948/K-JLM104910 Bearing 2D drawings and  
3D CAD models

Size	50x82x21.5 mm
Bore Diameter	50 mm
Outer Diameter	82 mm
Width	21,5 mm
d	50 mm
D	82 mm
T	21,5 mm
B	21,5 mm
C	17 mm
r min.	3 mm
r1 min.	3 mm
r2 min.	0,5 mm
S	5,3 mm
da max	55 mm
Da min	76 mm
Da max.	77 mm
db min	60 mm
Db min.	78 mm
ra max.	3 mm
rb max.	0,5 mm
Weight	0,431 Kg
Basic dynamic load rating (C)	75,2 kN
Basic static load rating (C0)	104 kN
(Grease) Lubrication Speed	4 500 r/min
(Oil) Lubrication Speed	6 000 r/min



## New energy Bearing Manufacturing Co.,...

Calculation factor (e)	0,31
Calculation factor (Y)	1,97