

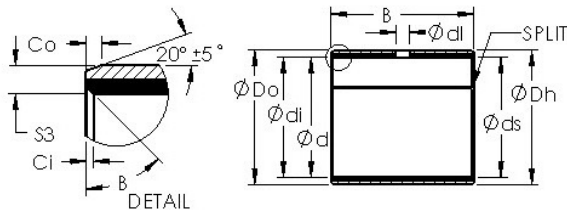

New energy Bearing Manufacturing Co.,...



AST AST40 10580 plain bearings

Bearing No. AST40 10580

Bore Diameter	105 mm
Outer Diameter	110 mm
Bearing Type	straight
Shaft Dia., Nominal (d)	105.0000
Shaft Size (ds) - 105 -0 / -0.054	105 0 / 0.054
Housing Bore Dia. (Dh)	110 +0.035 / +0
Bearing Outside Diameter, Nominal(Do)	110.000
Bearing Outside Diameter Tolerance (Do tol.)	110.12 / 110.07
Bearing Bore after Mounting (di)	105.155 / 105.02
Average Clearance (Cd)	0.1150
Wall Thickness (S3)	2.490
Bearing Length, Nominal (B)	80.000
Bearing Length Tolerance (B tol.) - +0 / -0.40	+0 / 0.40
OD Chamfer Length (Co)	1.800
ID Chamfer Angle (B deg.)	45
ID Chamfer Length (Ci)	0.600
Material	Steel shell with PTFE / Polymer Fiber lining

AST40 10580 Bearing 2D drawings and 3D CAD models