

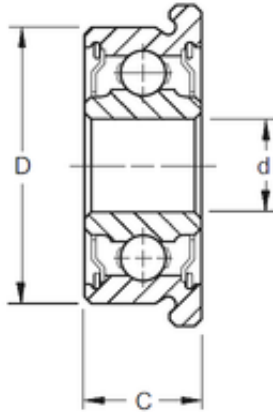

New energy Bearing Manufacturing Co.,...

6 mm x 13 mm x 5 mm ZEN F686-2RS deep groove ball bearings



Bearing No. F686-2RS

Size	6x13x5 mm
Bore Diameter	6 mm
Outer Diameter	13 mm
Width	5 mm
d	6 mm
D	13 mm
B	5 mm
C	5 mm
Basic dynamic load rating (C)	1,082 kN
Basic static load rating (C0)	0,442 kN

F686-2RS Bearing 2D drawings and 3D CAD models